

Contactors CWM from 112 up to 300 A (AC-3) - Overview

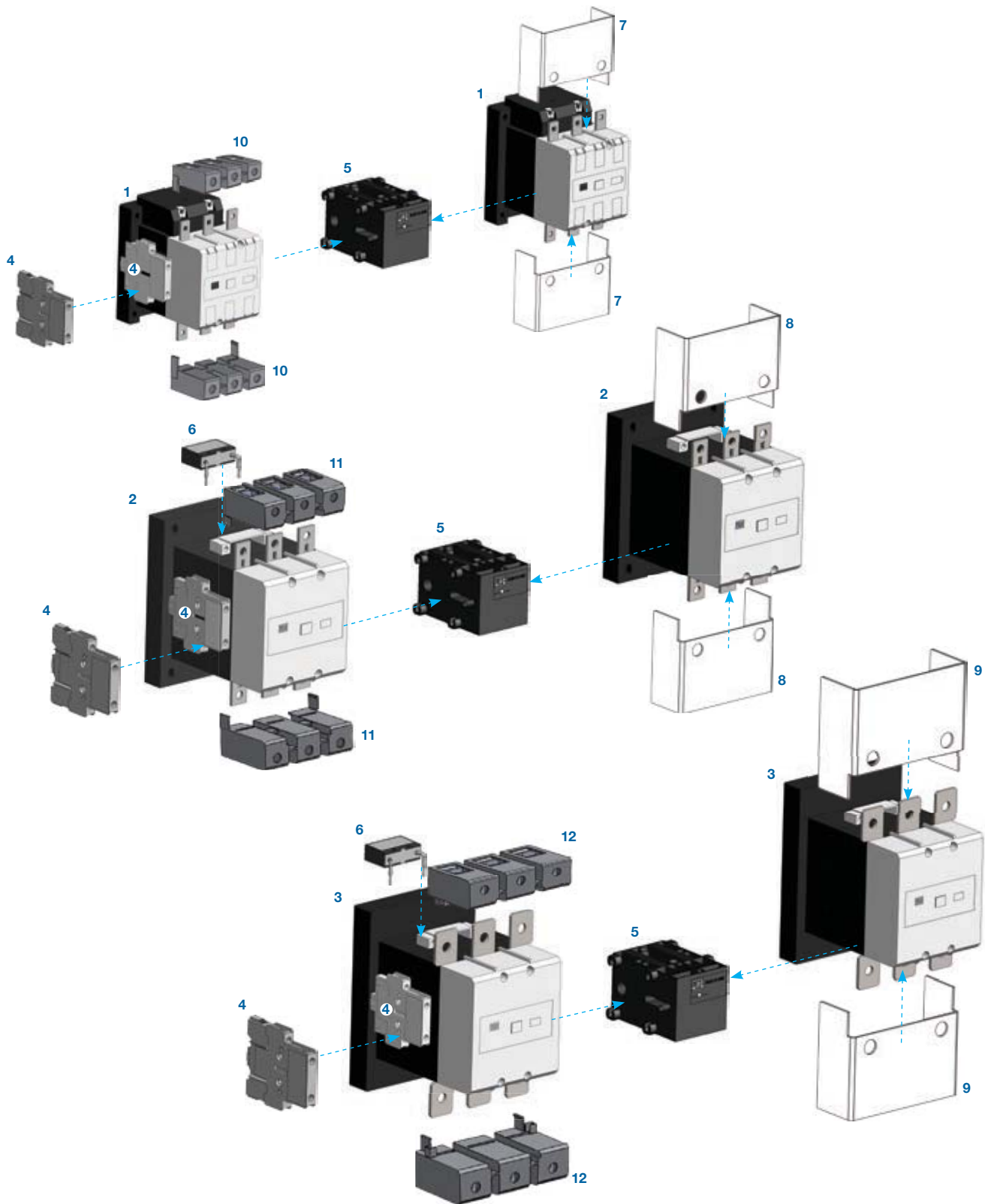

- 1 - Contactors CWM112/150
- 2 - Contactors CWM180
- 3 - Contactors CWM250/300
- 4 - Side mounting auxiliary contact block BCXML
- 5 - Mechanical interlock BLIM112-300
- 6 - Surge suppressor block BAMV

- 7 - Terminal cover BMP CWM150
- 8 - Terminal cover BMP CWM180
- 9 - Terminal cover BMP CWM300
- 10 - TB150 terminal block for CWM112-150
- 11 - TB180 terminal block for CWM180
- 12 - TB300 terminal block for CWM250-300